

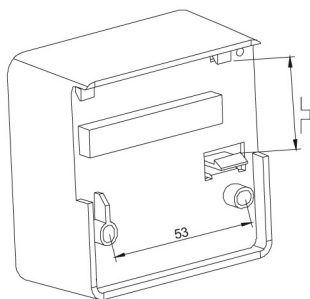

INSTALLAZIONE / FIXING

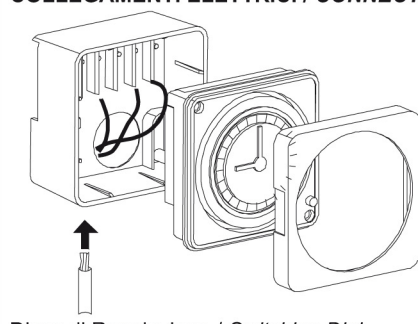

COLLEGAMENTI ELETTRICI / CONNECTIONS



Disco di Regolazione / Switching Dial

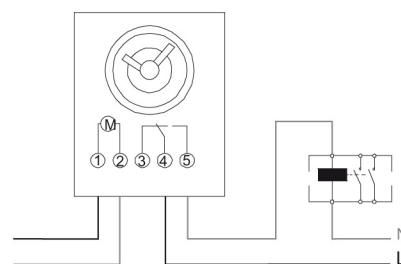

Alimentazione / Supply Voltage

IMPOSTAZIONE ORA / TIME SETTING

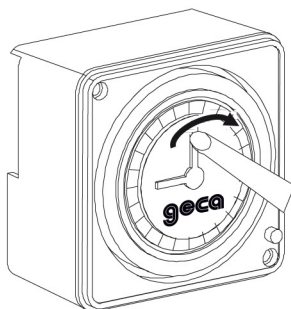

PROGRAMMAZIONE / PROGRAMMING

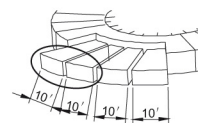
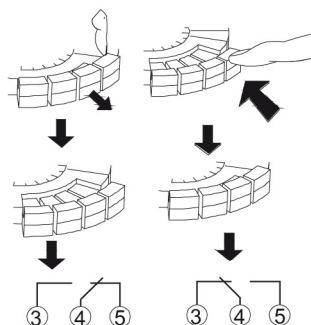

Intervallo minimo di commutazione: 20min
Minumun Interval Between Two Actions: 20min

FORZATURA MANUALE: ritorno al funzionamento automatico alla prossima commutazione
MANUAL OVERRIDE: switch back to automatic mode at the next switching action

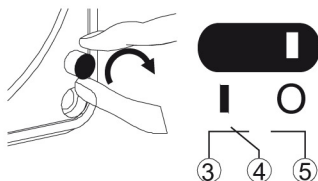
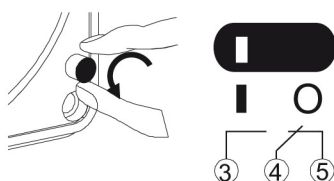

PORTATA CONTATTI / MAX LOAD

1 Contatto in Scambio
10A 250V~ AC1 Carico Resistivo
3A 250V~ Carico Induttivo $\cos\Phi = 0,6$
1000W Lampada ad Incandescenza

1 Changover Switch
10A 250V~ AC1 Resistive Load
3A 250V~ Inductive Load $\cos\Phi = 0,6$
1000W Incandescent Light

Alimentazione: 230V~ 50/60Hz
Tecnologia: Quarzo
Ciclo: 24h
Riserva di Carica: 72h (dopo 120h di carica)
Precisione: 1sec/24h
Consumo: 0,5VA
Temperatura di Funzionamento: -10°C a +50°C
Temperatura di Stoccaggio: -20°C a +55°C
Sezioni max. Allacciabili: 1 a 6mm²
Classe di Isolamento: II
Classe di Protezione: IP20



Supply: 230V~ 50/60Hz
Technology: Quartz
Cycle: 24h
Supply Failure Reserve: 72h (after beeing connected for 120h)
Accuracy: 1sec/24h
Consumption: 0,5VA
Working Temperature: -10°C a +50°C
Storage Temperature: -20°C a +55°C
Connection Capacity: 1 a 6mm²
Type of Insulation: II
Protection Degree: IP20

Dis. 2034043